

**INSTALLATION INSTRUCTIONS**  
**C-ACC-A-AUB-2X5X6, C-ACC-A-AUB-3X5X5 and**  
**C-ACC-A-MTSL Series**

Document:	LPN00485X0001A0_A	Date:	03-22-2017
Created By:	TMT		

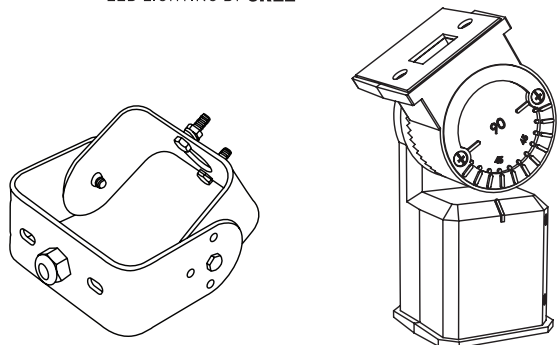

**SET BALLAST VOLTAGE**  
**(NOT REQUIRED FOR LED PRODUCTS)**

This fixture is normally equipped with a multitap ballast and is factory set to the highest voltage. If another voltage is desired:

**Ballast with Multiple Leads**

1. Disconnect highest voltage lead and recap with same wire connector.
2. Strip appropriate lead and connect to incoming hot lead using appropriate wire connectors.

**Single Voltage Tap**

1. Make sure the voltage furnished to the fixture is the same as specified on the unit.

**2" (51 MM) ADJUSTABLE FITTER MOUNTING**

1. Install gasket on upper fitter by aligning the (2) holes in the gasket with the (2) threaded bolt holes in the upper fitter.
2. Open fixture and remove reflector if necessary.
3. Align (2) threaded bolt holes on the upper fitter with the (2) bolt holes in the side of the fixture.
4. Fasten upper fitter to the fixture using the (2) bolts and lock washers supplied with fitter. Tighten bolts to 132 in-lbs (15 Nm).
5. Remove splice compartment cover from lower fitter.
6. Route fixture ground wire, common wire, and appropriate voltage tap wire thru fixture and into the fitter.
7. Strain relief is required for electrical connections on 2" (51 mm) adjustable fitter mounts at heights of 25' (7.6 m) and above. Tie a knot in the supply wires above the hole in the lower fitter wiring compartment to reduce the strain on the connections. Make sure knot will not slip through hole.
8. Slip lower fitter over 2-3/8" (60 mm) o.d. heavy wall pipe or tenon and securely tighten two Allen head set screws with 3/16" Allen wrench to 140 in-lbs (16 Nm). See **Figure 1**.
9. Make wire connections in splice compartment of adjustable fitter.
10. If photocell accessory is used, locate in cover of fitter splice compartment. See photocell installation sheet for details.
11. Adjust fixture to desired aiming angle. The fixture may be aimed at 2-1/2° increments. Markings are located on outside of fitter for ease of aiming. See **Figure 2 and 5** on back page.
12. Tighten 3/8" bolt in fitter splice compartment to approximately 19 ft. lbs. (25 N•m).

**FIGURE 1**

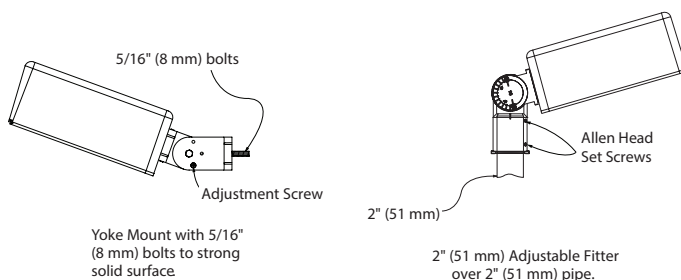

**CAUTIONS**

**IMPORTANT SAFEGUARDS**

When using electrical equipment, basic safety precautions should always be followed including the following:

**READ AND FOLLOW ALL SAFETY INSTRUCTIONS**

1. **DANGER**- Risk of shock- Disconnect power before installation.  
**DANGER – Risque de choc – Couper l'alimentation avant l'installation.**
2. This luminaire must be installed in accordance with the NEC or your local electrical code. If you are not familiar with these codes and requirements, consult a qualified electrician.  
*Ce produit doit être installé conformément à NEC ou votre code électrique local. Si vous n'êtes pas familier avec ces codes et ces exigences, veuillez contacter un électricien qualifié.*
3. In continuously operating Metal Halide systems (24 hours/day, 7 days/week) using Metal Halide lamps, turn lamps off once per week for at least 15 minutes. Failure to comply increases the risk of violent lamp failure.

**SAVE THESE INSTRUCTIONS FOR FUTURE REFERENCE**

**Notes:**

1. Strain relief is required for electrical connections on 2" (51 mm) adjustable fitter mounts at heights of 25' (7.6 m) and above. Tie a knot in the supply wires above the hole in the lower fitter wiring compartment to reduce the strain on the connections. Make sure knot will not slip through hole.
2. All wire connectors within the fixture must be rated for 150°C minimum.
3. If fixture is supplied with an up light door frame (standard on sign light series) it should not be used as a down light.

# INSTALLATION INSTRUCTIONS

## C-ACC-A-AUB-2X5X6, C-ACC-A-AUB-3X5X5 and C-ACC-A-MTSL Series

**FIGURE 2 - 2" (51 mm) Adjustable Fitter Positions**

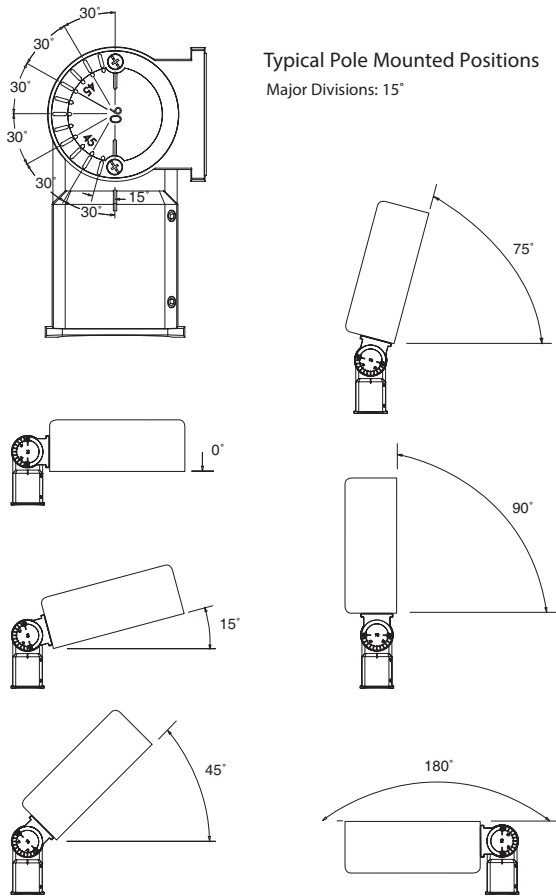

**FIGURE 3 — YOKE MOUNTING**

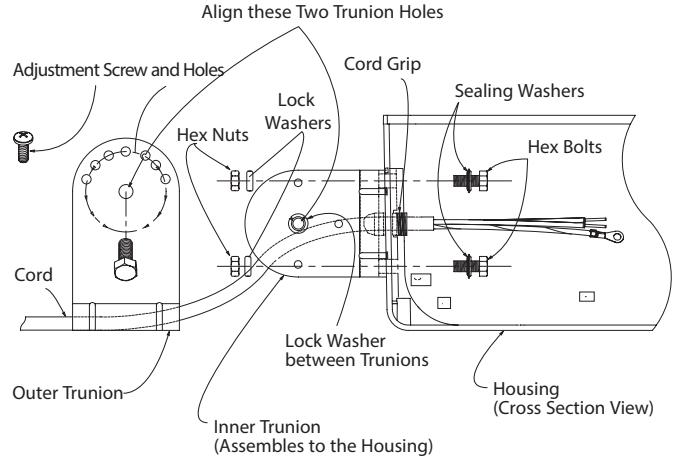

**FIGURE 4A — MOUNTING TO SURFACE**

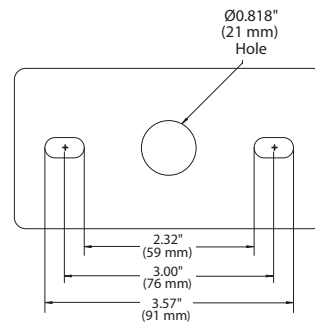

**FIGURE 4B — MOUNTING TO FIXTURE**

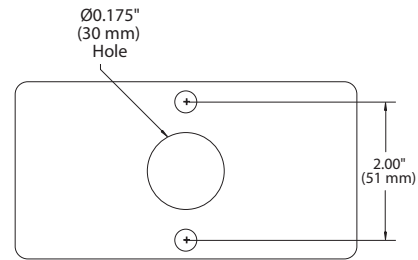

### YOKE MOUNTING

1. Attach yoke to fixture as shown in **Figure 3**.  
**NOTE:** When installing sealing washers make sure the rubber side is facing housing wall.
2. Slide (2) lock washers over yoke bolts.
3. Secure yoke to housing with (2) 5/16" nuts. Tighten nuts to 132 in-lbs (15 Nm).
4. Insert cord thru cord grip so that the leads with the ground lug extend from the threaded side of the cord grip by 4" or as needed to reach ground lug in fixture. Tighten cord grip firmly to cord.
5. Insert cord into fixture and fasten cord grip to housing as shown in **Figure 3**.
6. Connect cord ground wire to fixture ground. Connect cord white wire to ballast common wire. Connect cord black wire to appropriate ballast voltage tap wire.  
**NOTE:** Use supplied 150°C wire nuts to make all electrical connections within the fixture.
7. Mount fixture using three 3/8" (10 mm) bolts appropriate for mounting surface. See **Figure 4a**.

### TO AIM FIXTURE:

1. Remove #10-24 positioning screw.
  2. Loosen both 5/16-18 hex head bolts on sides of yoke.
  3. Rotate yoke to desired angle. Line up inner and outer yoke positioning holes.
  4. Insert #10-24 screw into matching holes of inner and outer yokes, and tighten.
  5. Retighten 5/16-18 hex head bolts.
- NOTE:** For typical sign light position See **Figure 5**.

**FIGURE 5 — TYPICAL SIGN LIGHT POSITION**

